



## FRB – PLENUM BOX WITH MOTORIZED OPENING

*Fire Roof Box: Axial fan in plenum box with motorized hatch*

Solutions with plenum boxes in vertical flow with a motorized cover with or without connection to the inlet are available from diameter 400 to diameter 1250 for motors with a frame size up to 225.

### Standard construction

- Housing in Z275 pre-galvanized steel
- Certified for 10,000 opening-closing cycles
- WL1500 wind resistance and SL500 weight resistance
- Suitable for snowy, windy or sandy environments

### Option:

- Epoxy paint
- Stainless steel

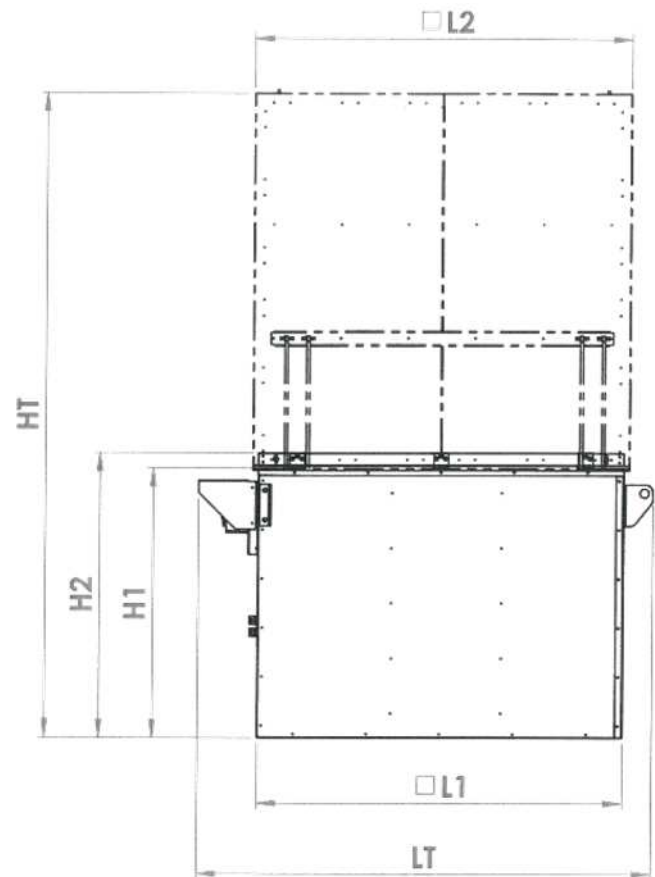

Size	Hatch	D	□L1	□L2	LT	H1	H2	HT	Weight*
Small	FRB-S0400	∅ 400	955	990	1315	900	965	1880	139
	FRB-S0450	∅ 450							141
	FRB-S0500	∅ 500							143
	FRB-S0560	∅ 560							145
Medium	FRB-M0630	∅ 630	1205	1240	1565	1100	1165	2335	200
	FRB-M0710	∅ 710							203
	FRB-M0800	∅ 800							206
Large	FRB-L0900	∅ 900	1495	1540	1855	1100	1165	2635	260
	FRB-L1000	∅ 1000							264
X-Large	FRB-X1120	∅ 1120	1805	1850	2165	1355	1415	3173	420
	FRB-X1250	∅ 1250							425

Dimensions are in mm; \*Weights (in kg) without the fan.